

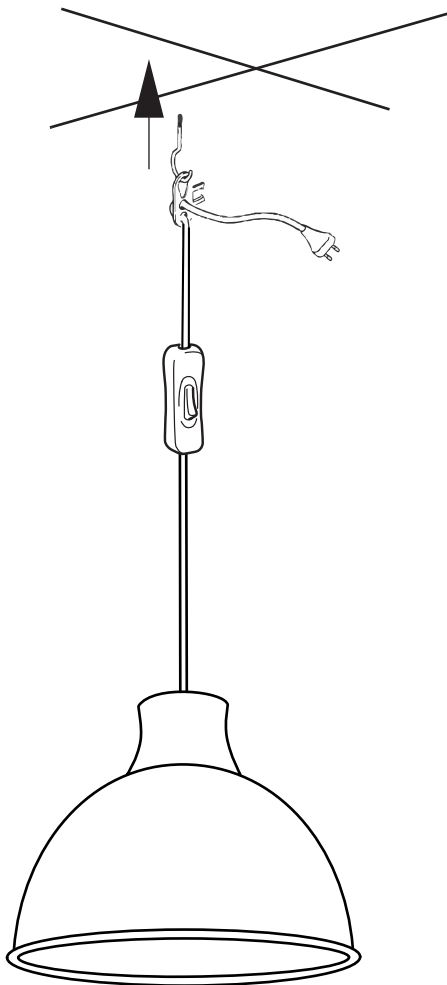

# PFLANZENLEUCHE FLORABOOSTER® 500

## INSTALLATION

(1) Verwendung mit Eurostecker



(2) Verwendung mit Deckenstromanschluß

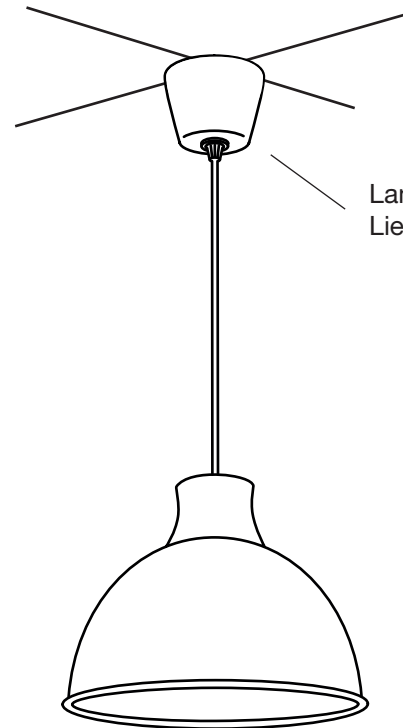
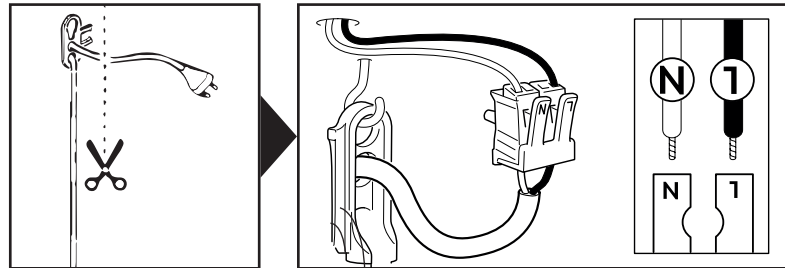

## Vorsicht:

Bitte schalten Sie immer den Strom ab, bevor Sie die Pflanzenleuchte installieren, reinigen oder warten.

Es dürfen ausschließlich Speziallampen verwendet werden. Bei Verwendung von Glühlampen oder anderen Lampen riskieren Sie einen elektrischen Schlag oder Feuer!

Modell: LUM 500  
Spannung: 220-240V AC  
Frequenz: 50-60 Hz  
Max. Leistungsaufnahme: 40W

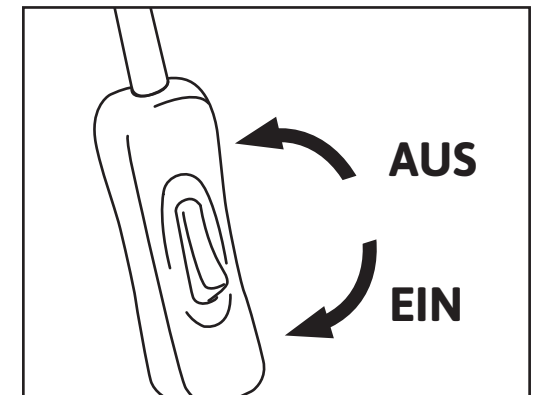



# PLANT LIGHT FLORABOOSTER® 500

## INSTALLATION

(1) Use with Euro plug

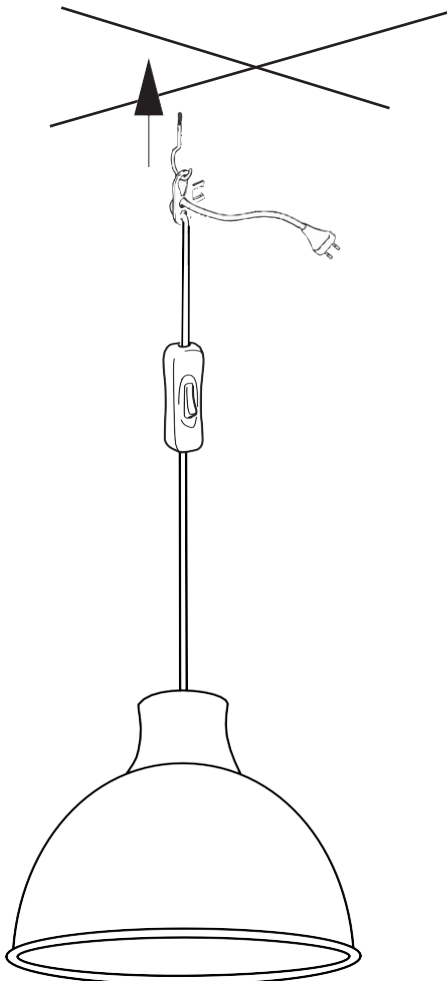

(2) Use with ceiling power connection

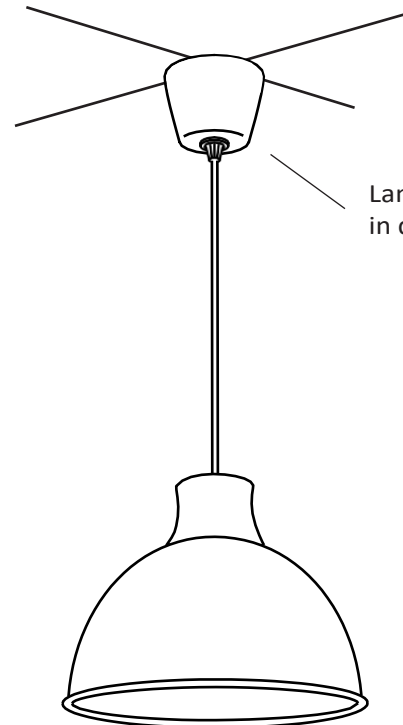
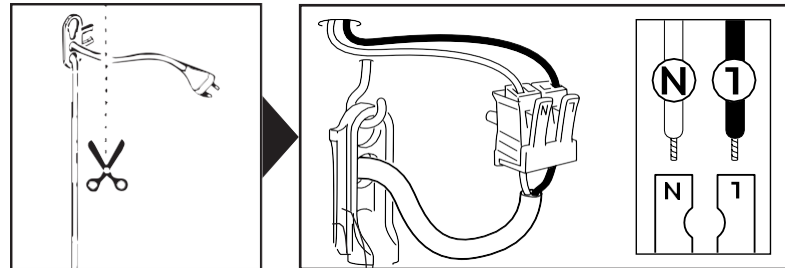

## Caution:

Please always switch off the power before installing, cleaning or servicing the plant light.

Only special lamps may be used. If you use incandescent bulbs or other lamps, you risk electric shock or fire!

Model: LUM 500  
Voltage: 220-240V AC  
Frequency: 50-60 Hz  
Max. Power consumption: 40 W

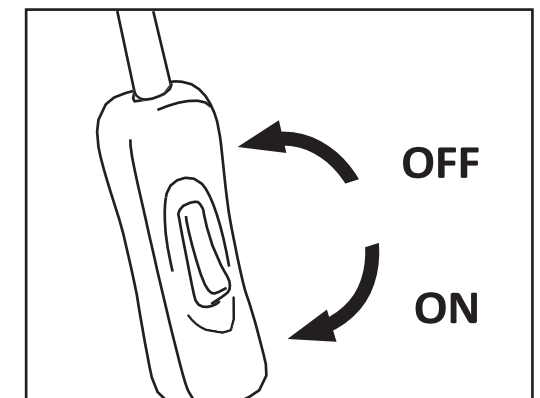



# PLANT LIGHT FLORABOOSTER® 500

## INSTALLATION

### (1) Brug med euro-stik

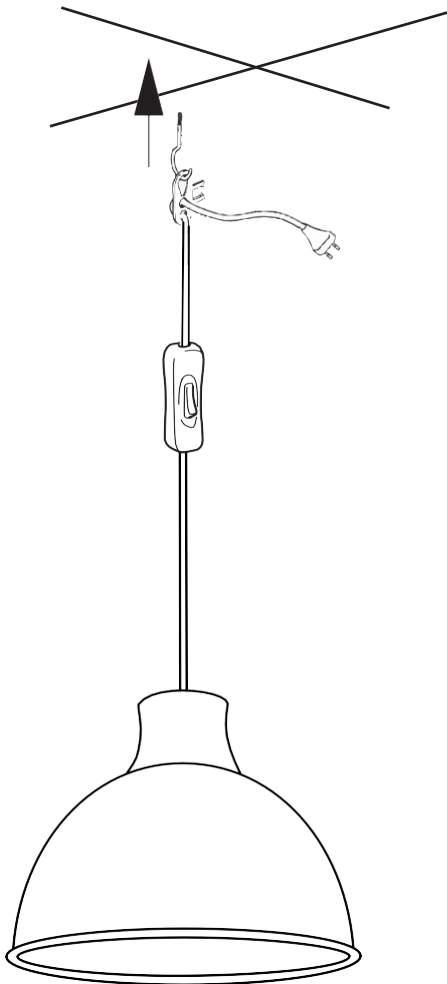

### (2) Anvendelse med strømtilslutning til loftet

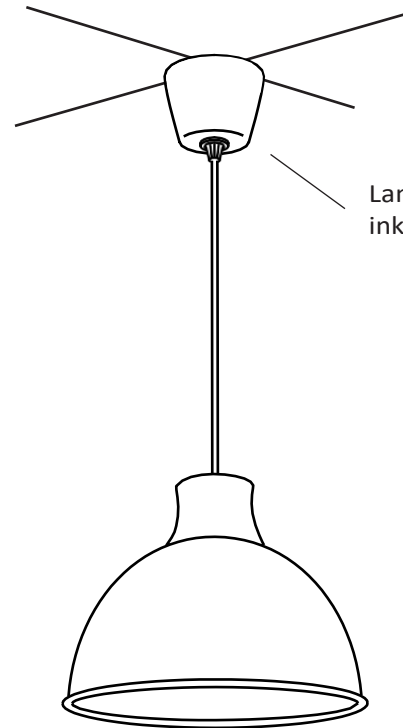
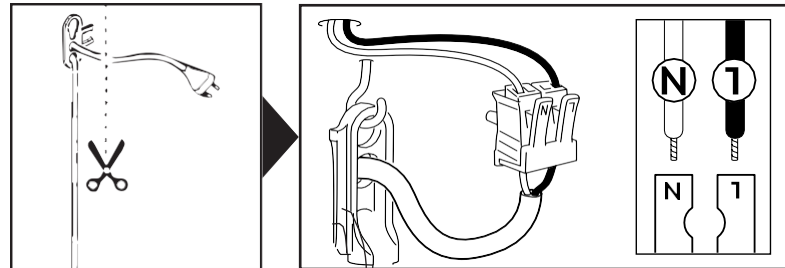

## Forsigtig:

Sluk altid for strømmen, før du installerer, rengør eller foretager service på plantelyset.

Der må kun anvendes speciallamper. Hvis du bruger glødepærer eller andre lamper, risikerer du elektrisk stød eller brand!

Model: LUM 500  
Spænding: 220-240V AC  
Hyppighed: 50-60 Hz  
Max. Strømforbrug: 40 W

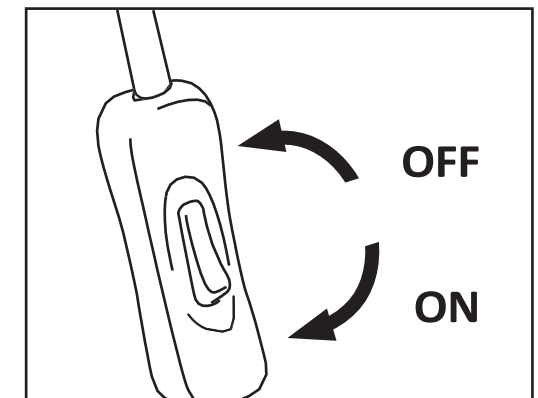



# KASVIVALO FLORABOOSTER® 500

## ASENNUS

### (1) Käyttö europistokkeen kanssa

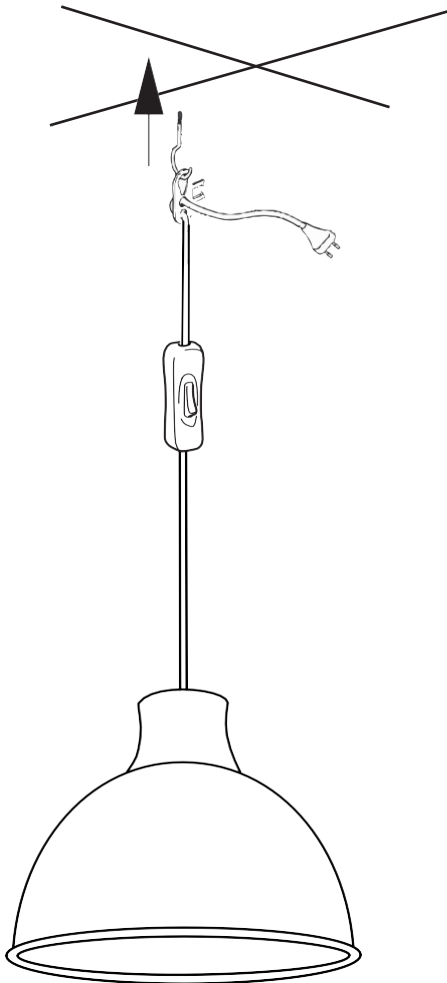

### (2) Käyttö kattovirtaliitännän kanssa

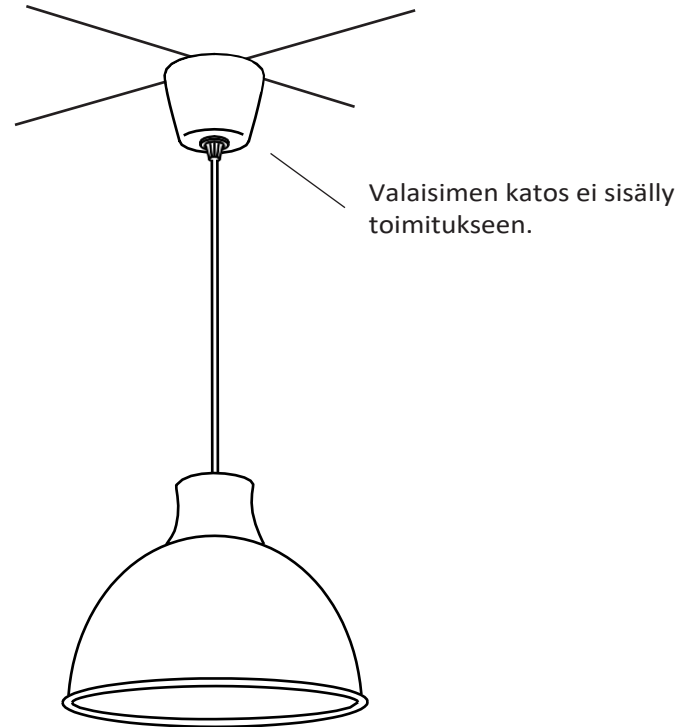
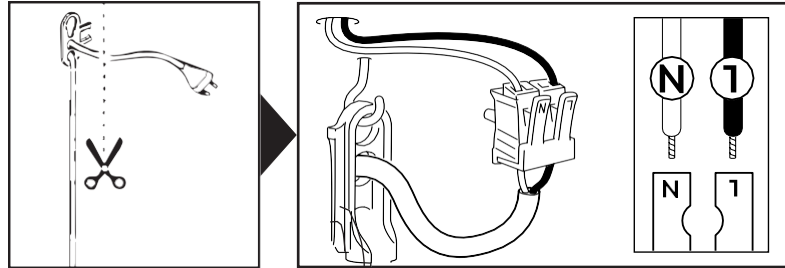

## Varoitus:

Kytke aina virta pois päältä, ennen kuin asennat, puhdistat tai huollat kasvivalaisinta.

Ainoastaan erikoislamppuja saa käyttää. Jos käytät hehkulamppuja tai muita lamppuja, vaarana on sähköisku tai tulipalo!

Malli: LUM 500  
Jännite: 220-240V AC  
Taajuus: 50-60 Hz  
Max. Virrankulutus: 40 W

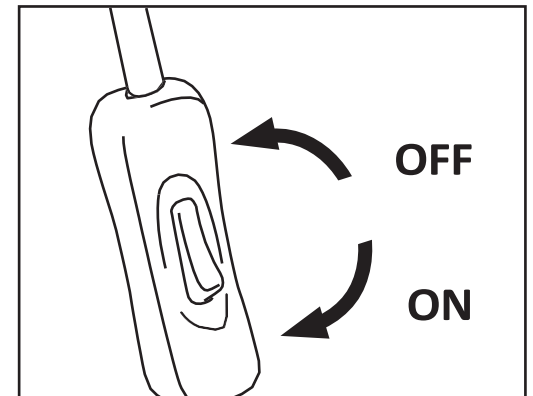



# PLANTELYS FLORABOOSTER® 500

## INSTALLASJON

### (1) Bruk med europlugg

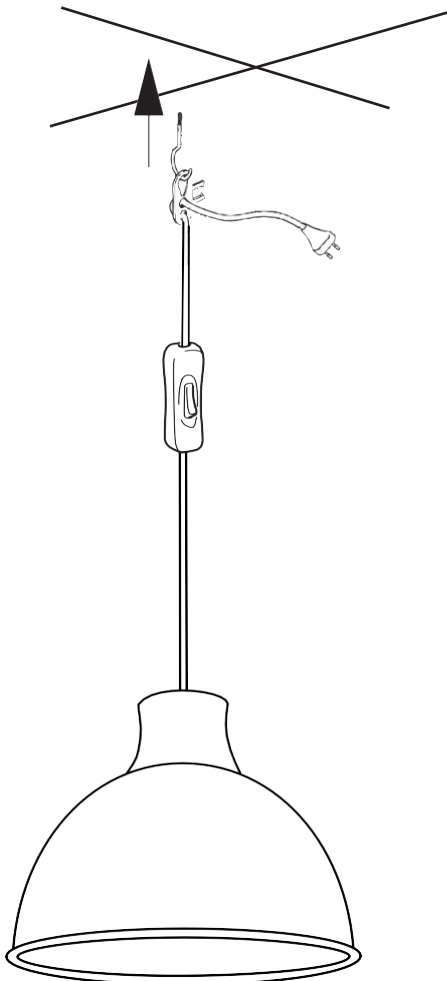

### (2) Bruk med strømtilkobling i taket

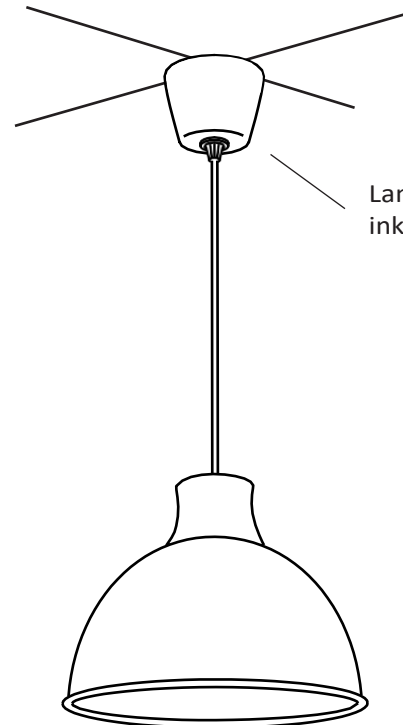
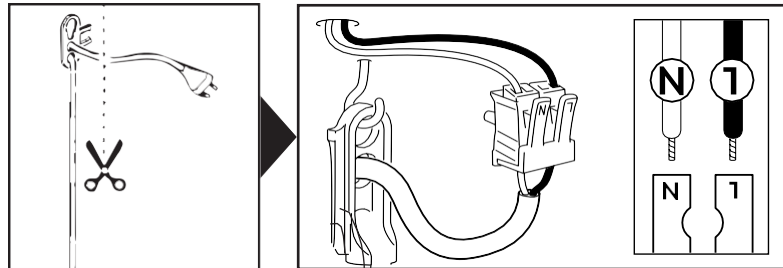

Lampebaldakin ikke inkludert i leveransen.

## Forsiktig:

Slå alltid av strømmen før du installerer, rengjør eller utfører service på plantelyset.

Kun spesiallamper kan brukes. Hvis du bruker glødelamper eller andre lamper, risikerer du elektrisk støt eller brann!

Modell: LUM 500  
Spenning: 220-240V  
Frekvens: 50-60 Hz  
Maks. Strømforbruk: 40 W

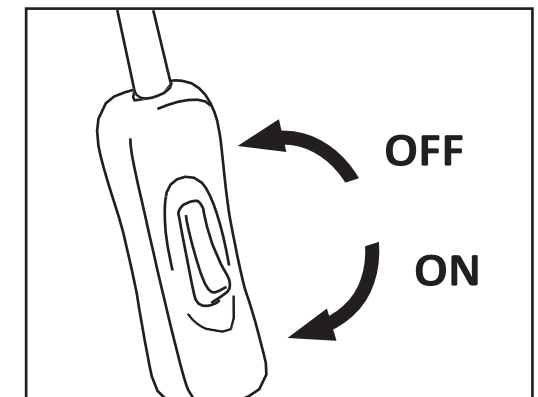

## INSTALLATION

### (1) Används med euro-kontakt

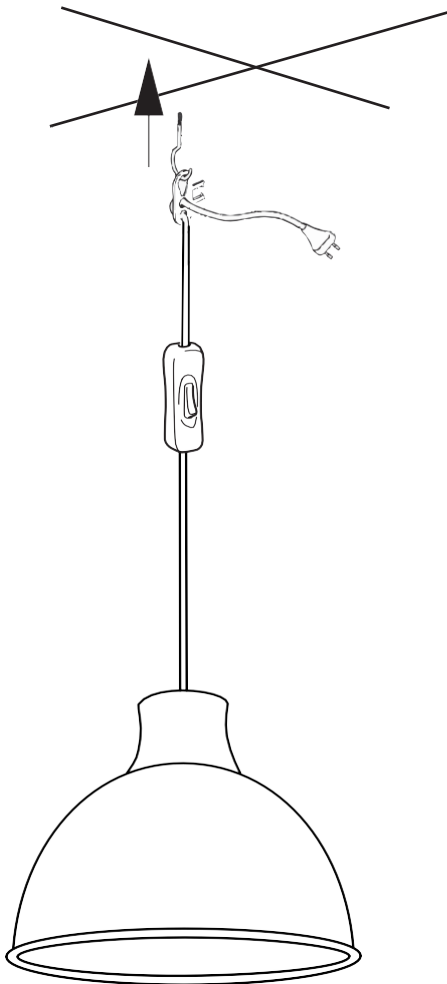

### (2) Användning med takströmsanslutning

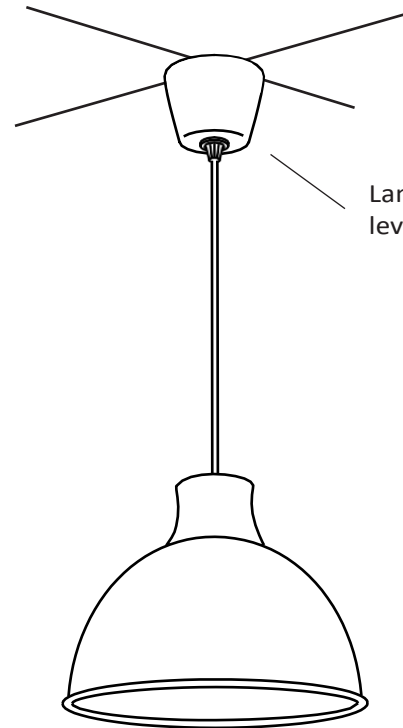
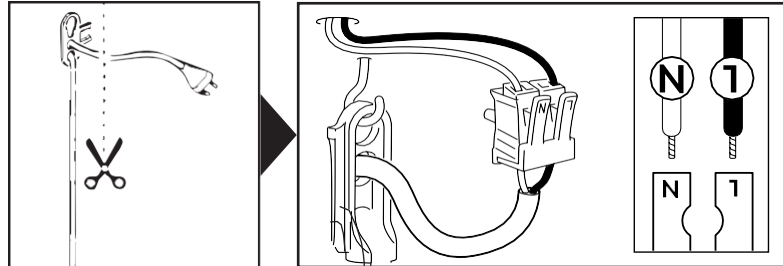

## Försiktigt:

Stäng alltid av strömmen innan du installerar, rengör eller servar lampan.

Endast särskilda lampor får användas. Om du använder glödlampor eller andra lampor riskerar du elektriska stötar eller brand!

Modell: LUM 500  
 Spänning: 220-240V AC  
 Frekvens: 50-60 Hz  
 Max. Strömförbrukning: 40 W

